



2022 Price List

# MEIKO's Extended Warranty and Pro-Activ Service Programs



## Extended Warranty



Extend your MEIKO **Standard Limited Warranty** for an additional year! See pages 20-21 which contain in-depth information, covered service levels and complete details about warranty terms, conditions and exclusions.

## MEIKO Pro-Activ Service, one-year program



When your machine turns a year old, we'll schedule a visit from a MEIKO field engineer or authorized service agent who'll provide a thorough inspection of your machine, make any needed adjustments, replace specific wear-related parts, and provide a summary of any further recommended service. This program includes monthly, bi-annual, and annual service checklist items. [ASK AN AGENT FOR DETAILS.](#)

## MEIKO Pro-Activ Service, two-year program



A year after your machine's installation, and 24 months after installation, a MEIKO field engineer or authorized service agent will visit you to provide a complete inspection, make any needed adjustments, replace specific wear-related parts, and provide a summary of any additional recommended service. This service includes monthly, bi-annual, and annual service checklist items. [ASK AN AGENT FOR DETAILS.](#)

## MEIKO Performance and Installation (P&I) Inspection Program: Activates Your Warranty



**At no charge to you,** we'll inspect your newly installed equipment to ensure it's in good working order with proper set-up and utility connections. Completion of our P&I program will officially activate your customer warranty.

For additional information, contact MEIKO's Service Department at  
**1-800-868-3840 or e-mail: [service@meiko.us](mailto:service@meiko.us).**



## Say goodbye to steam and drops with MEIKO's new M-iClean U with ComfortAir™ technology

Our innovative new heat-recovery system reduces steam by up to 80% for incredibly fast drying time, reducing moisture on dishes by as much 98%, and up to 75% on glassware. That saves time and labor, and creates a cooler work environment.

ComfortAir™ keeps the steam in the machine for use as an energy source to help lower operating costs, too. Its quiet, new ventless design is cool to the touch to optimize front-of-house performance. It's so quiet and efficient in fact, that bars and restaurants can now keep their commercial dishwashers up front and center without disturbing customer dining or bar experiences.



Only MEIKO combines the industry's most sustainable warewashing technology with maximum cleanliness, for a clean like you've never seen. *AVAILABLE IN ALL MODELS.*

M-iCLEAN UM WITH COMFORT AIR™ AND GiO MODULE | Undercounter Glasswasher 



For the ultimate in sparkling glassware, the M-iClean UM with GiO Module uses an integrated reverse osmosis system to remove dissolved salts and soils. The cleanest possible rinse water provides brilliant clean, virtually eliminating the need for hand polishing glasses.

**CAPACITY:**  
23 racks / hour, 828 glasses / hour

**RINSE WATER CONSUMPTION:**  
14.03 gals. (53.13 liters) / hour  
0.61 gals. (2.31 liters) / rack

**CONCENTRATE WATER CONSUMPTION:**  
24.61 gals. (93.15 liters) / hour  
1.07 gals. (4.05 liters) / rack

**WATER SUPPLY TEMPERATURE:**  
Cold as available; 70°F (21°C) recommended

**VOLTAGES:**  
208-230V / 60Hz / 1Ph  
208-230V / 60Hz / 3Ph

**DISPENSERS:**  
Standard liquid detergent and rinse aid pumps

**LIST PRICE:**  
**\$17,845**

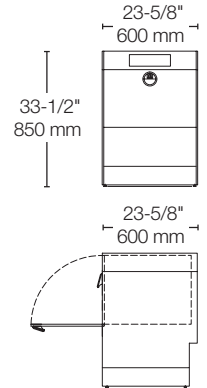

M-iCLEAN UM+ WITH COMFORT AIR™ | Undercounter Dishwasher 



The M-iClean UM+ commercial undercounter dishwasher has the industry's most sustainable cleaning technology combined with a modern, sleek design. Dishwashing has never been so cost-effective, environmentally friendly or attractive.

**CAPACITY:**  
37 racks / hour, 925 dishes / hour

**WATER CONSUMPTION:**  
22.57 gals. (85.44 liters) / hour  
0.61 gals. (2.31 liters) / rack

**WATER SUPPLY TEMPERATURE:**  
Any; 140°F (60°C) recommended

**VOLTAGES:**  
208-230V / 60Hz / 1Ph  
208-230V / 60Hz / 3Ph

**DISPENSERS:**  
Standard liquid detergent and rinse aid pumps

**LIST PRICE:**  
**\$13,720**

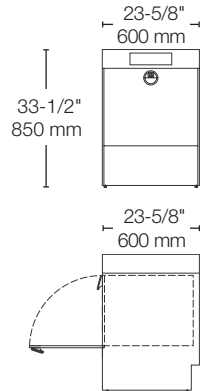

M-iCLEAN UM WITH COMFORT AIR™ | Undercounter Glasswasher 



Though designed to be a glasswasher, the M-iClean UM impresses with its ability to clean more than just glasses and stemware in its sizeable wash chamber. No matter the dish, flatware or barware, it provides brilliantly clean dishes every time.

**CAPACITY:**  
37 racks / hour, 1,332 glasses / hour

**WATER CONSUMPTION:**  
22.57 gals. (85.44 liters) / hour  
0.61 gals. (2.31 liters) / rack

**WATER SUPPLY TEMPERATURE:**  
Any; 140°F (60°C) recommended

**VOLTAGES:**  
208-230V / 60Hz / 1Ph  
208-230V / 60Hz / 3Ph

**DISPENSERS:**  
Standard liquid detergent and rinse aid pumps

**LIST PRICE:**  
**\$13,195**

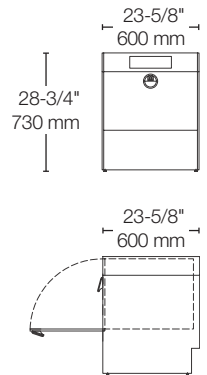

M-iCLEAN US WITH COMFORT AIR™ | Undercounter Glasswasher



The M-iClean US is designed to fit in small spaces and give big results! Beautifully designed for the front of the house, with innovative technology, it hits every mark down to the very last detail.

**CAPACITY:**  
37 racks / hour, 592 glasses / hour

**WATER CONSUMPTION:**  
20.35 gals. (77.03 liters) / hour  
0.55 gals. (2.08 liters) / rack

**WATER SUPPLY TEMPERATURE:**  
Any; 140°F (60°C) recommended

**VOLTAGES:**  
208-230V / 60Hz / 1Ph  
208-230V / 60Hz / 3Ph

**DISPENSERS:**  
Standard liquid detergent  
and rinse aid pumps

**LIST PRICE:**  
**\$12,650**

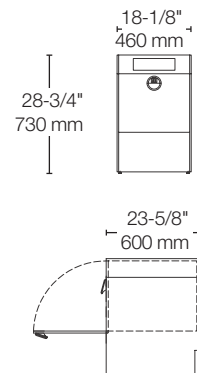

**Options and Accessories for M-iClean U-Series Undercounter Warewashers**

Plug kit (M-iClean UM+, UM, three-phase only - includes NEMA 15-50P plug, receptacle and plate) .....	\$580
Plug kit (M-iClean US, three-phase - includes NEMA 15-40P plug, receptacle and plate).....	\$535
Plug kit (M-iClean US, single-phase - includes NEMA 6-50P plug, receptacle and plate).....	\$535
Drain water tempering kit (installed by others).....	\$925
Drain board top (M-iClean UM+, UM).....	\$1,215
Peg rack, 20" x 20" (500 x 500 mm) - M-iClean UM+, UM.....	\$110
Combination flat rack, 20" x 20" (500 x 500 mm) - M-iClean UM+, UM .....	\$110
Coated wire glass rack, 20" x 20" (500 x 500 mm) - M-iClean UM+, UM.....	\$255
Combination flat rack, 15-3/4" x 15-3/4" (400 x 400 mm) - M-iClean US .....	\$115
Sixteen compartment divided glass rack, 15-3/4" x 15-3/4" (400 x 400 mm) - M-iClean US .....	\$225
Coated wire glass rack, 15-3/4" x 15-3/4" (400 x 400 mm) - M-iClean US.....	\$235
Plate insert peg adaptor (snaps into flat rack – set of 2).....	\$35
Inline slide base, adds 1" (25 mm) to machine height .....	\$170
Framed base with individual 6" legs, adds 6" (152 mm) to machine height .....	\$865
Flush-paneled stainless steel base, adds 4-3/4" (120 mm) to machine height.....	\$415
Flush-paneled stainless steel cabinet base, adds 15-3/4" (400 mm) to machine height- M-iClean UM+, UM .....	\$1,730
Flush-paneled stainless steel cabinet base with 6" (152 mm) legs, adds 21-3/4" (550 mm) to machine height - M-iClean UM+, UM .....	\$2,205

<b>Standard parts and labor warranty, first year .....</b>	<b>No charge</b>
 Extended warranty, additional 12 months.....	NET \$1,240
 MEIKO Pro-Activ Service, one year (see page 2).....	NET \$1,095
 MEIKO Pro-Activ Service, two years (see page 2).....	NET \$2,150
Liftgate delivery.....	NET \$195
Notify before delivery fee.....	No charge
Inside delivery (consult factory with site details prior to quoting) .....	NET \$150
Guaranteed delivery date.....	Consult factory

M-iCLEAN UM+ | Undercounter Dishwasher 



The M-iClean UM+ commercial undercounter dishwasher has the industry's most sustainable cleaning technology combined with a modern, sleek design. Dishwashing has never been so cost-effective, environmentally friendly or attractive.

**CAPACITY:**  
37 racks / hour, 925 dishes / hour

**WATER CONSUMPTION:**  
22.57 gals. (85.44 liters) / hour  
0.61 gals. (2.31 liters) / rack

**WATER SUPPLY TEMPERATURE:**  
Any; 140°F (60°C) recommended

**VOLTAGES:**  
208-230V / 60Hz / 1Ph  
208-230V / 60Hz / 3Ph

**DISPENSERS:**  
Standard liquid detergent  
and rinse aid pumps

**LIST PRICE:**  
**\$12,420**

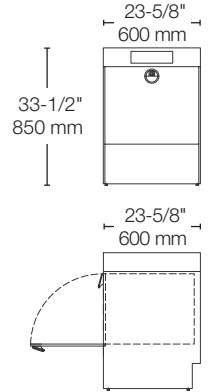

M-iCLEAN UM | Undercounter Glasswasher 



Though designed to be a glasswasher, the M-iClean UM impresses with its ability to clean more than just glasses and stemware in its sizeable wash chamber. No matter the dish, flatware or barware, it provides brilliantly clean dishes every time.

**CAPACITY:**  
37 racks / hour, 1,332 glasses / hour

**WATER CONSUMPTION:**  
22.57 gals. (85.44 liters) / hour  
0.61 gals. (2.31 liters) / rack

**WATER SUPPLY TEMPERATURE:**  
Any; 140°F (60°C) recommended

**VOLTAGES:**  
208-230V / 60Hz / 1Ph  
208-230V / 60Hz / 3Ph

**DISPENSERS:**  
Standard liquid detergent  
and rinse aid pumps

**LIST PRICE:**  
**\$11,900**

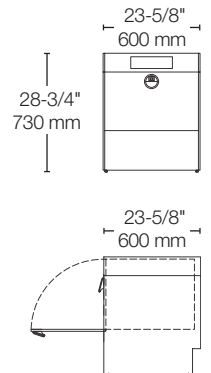

M-iCLEAN US | Undercounter Glasswasher 



The M-iClean US is designed to fit in small spaces and give big results! Beautifully designed for the front of the house, with innovative technology, it hits every mark down to the very last detail.

**CAPACITY:**  
37 racks / hour, 592 glasses / hour

**WATER CONSUMPTION:**  
20.35 gals. (77.03 liters) / hour  
0.55 gals. (2.08 liters) / rack

**WATER SUPPLY TEMPERATURE:**  
Any; 140°F (60°C) recommended

**VOLTAGES:**  
208-230V / 60Hz / 1Ph  
208-230V / 60Hz / 3Ph

**DISPENSERS:**  
Standard liquid detergent  
and rinse aid pumps

**LIST PRICE:**  
**\$11,355**

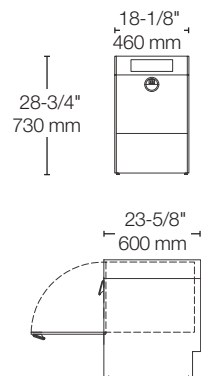

M-iCLEAN UM WITH GiO MODULE | Undercounter Glasswasher



For the ultimate in sparkling glassware, the M-iClean UM with GiO Module uses an integrated reverse osmosis system to remove dissolved salts and soils. The cleanest possible rinse water provides brilliant clean, virtually eliminating the need for hand polishing glasses.

**CAPACITY:**  
14 racks / hour, 828 glasses / hour

**RINSE WATER CONSUMPTION:**  
14.03 gals. (53.13 liters) / hour  
0.61 gals. (2.31 liters) / rack

**CONCENTRATE WATER CONSUMPTION:**  
24.61 gals. (93.15 liters) / hour  
1.07 gals. (4.05 liters) / rack

**WATER SUPPLY TEMPERATURE:**  
Cold as available; 70°F (21°C) recommended

**VOLTAGES:**  
208-230V / 60Hz / 1Ph  
208-230V / 60Hz / 3Ph

**DISPENSERS:**  
Standard liquid detergent and rinse aid pumps

**LIST PRICE:**  
**\$16,550**

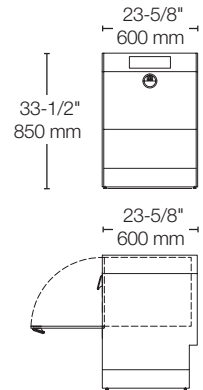

Options and Accessories for M-iClean U-Series Undercounter Warewashers

Plug kit (M-iClean UM+, UM, three-phase only - includes NEMA 15-50P plug, receptacle and plate) .....	\$580
Plug kit (M-iClean US, three-phase - includes NEMA 15-40P plug, receptacle and plate).....	\$535
Plug kit (M-iClean US, single-phase - includes NEMA 6-50P plug, receptacle and plate).....	\$535
Drain water tempering kit (installed by others).....	\$925
Drain board top (M-iClean UM+, UM).....	\$1,215
Peg rack, 20" x 20" (500 x 500 mm) - M-iClean UM+, UM.....	\$110
Combination flat rack, 20" x 20" (500 x 500 mm) - M-iClean UM+, UM .....	\$110
Coated wire glass rack, 20" x 20" (500 x 500 mm) - M-iClean UM+, UM.....	\$255
Combination flat rack, 15-3/4" x 15-3/4" (400 x 400 mm) - M-iClean US .....	\$115
Sixteen compartment divided glass rack, 15-3/4" x 15-3/4" (400 x 400 mm) - M-iClean US .....	\$225
Coated wire glass rack, 15-3/4" x 15-3/4" (400 x 400 mm) - M-iClean US.....	\$235
Plate insert peg adaptor (snaps into flat rack – set of 2).....	\$35
Inline slide base, adds 1" (25 mm) to machine height .....	\$170
Framed base with individual 6" legs, adds 6" (152 mm) to machine height .....	\$865
Flush-paneled stainless steel base, adds 4-3/4" (120 mm) to machine height.....	\$415
Flush-paneled stainless steel cabinet base, adds 15-3/4" (400 mm) to machine height- M-iClean UM+, UM .....	\$1,730
Flush-paneled stainless steel cabinet base with 6" (152 mm) legs, adds 21-3/4" (550 mm) to machine height - M-iClean UM+, UM .....	\$2,205

<b>Standard parts and labor warranty, first year .....</b>	<b>No charge</b>
🛡️ Extended warranty, additional 12 months.....	NET \$1,240
🔧 MEIKO Pro-Activ Service, one year (see page 2).....	NET \$1,095
🔧 MEIKO Pro-Activ Service, two years (see page 2).....	NET \$2,150
Liftgate delivery.....	NET \$195
Notify before delivery fee.....	No charge
Inside delivery (consult factory with site details prior to quoting) .....	NET \$150
Guaranteed delivery date.....	Consult factory

**FV 40.2** | Undercounter Dishwasher 



Good things come in small packages, and the FV 40.2 undercounter dishwasher packs in a lot, combining innovative, labor-saving technology with incredible cleaning performance – all in an attractive, space-saving package.

**CAPACITY:**  
37 racks / hour, 925 dishes / hour

**WATER CONSUMPTION:**  
24.42 gals. (92.44 liters) / hour  
0.66 gals. (2.50 liters) / rack

**WATER SUPPLY TEMPERATURE:**  
Any; 140°F (60°C) recommended

**VOLTAGES:**  
208-230V / 60Hz / 1Ph  
208-230V / 60Hz / 3Ph

**DISPENSERS:**  
Standard liquid detergent  
and rinse aid pumps

**LIST PRICE:**  
**\$10,245**

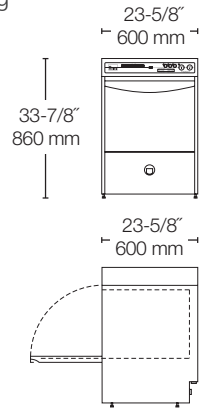

**FV 40.2 G** | Undercounter Glasswasher 



The FV 40.2 G has all of the great features of the standard FV 40.2, but in a size that's optimized for use in bars, coffee houses and kiosks. With a space-saving height of just 29-1/2" (1,750 mm), the FV 40.2 G fits comfortably under shorter countertops, and delivers the same sparkling clean as the FV 40.2.

**CAPACITY:**  
37 racks / hour, 1,332 glasses / hour

**WATER CONSUMPTION:**  
24.42 gals. (92.44 liters) / hour  
0.66 gals. (2.50 liters) / rack

**WATER SUPPLY TEMPERATURE:**  
Any; 140°F (60°C) recommended

**VOLTAGES:**  
208-230V / 60Hz / 1Ph  
208-230V / 60Hz / 3Ph

**DISPENSERS:**  
Standard liquid detergent  
and rinse aid pumps

**LIST PRICE:**  
**\$9,615**

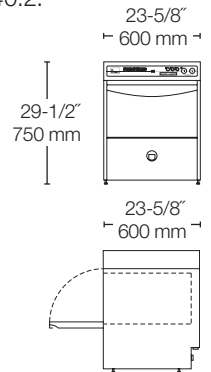





### Options and Accessories for the FV Series Undercounter Warewashers

Power cord kit (three-phase only - includes cord, NEMA 15-50P plug, receptacle and plate) .....	\$500
Drain water tempering kit (installed by others).....	\$925
Inline roller frame (does not increase height) .....	\$465
Drain board top .....	\$1,215
Peg rack, 20" x 20" (500 x 500 mm) .....	\$110
Combination rack, 20" x 20" (500 x 500 mm).....	\$110
Coated wire glass rack, 20" x 20" (500 x 500 mm) - for FV 40.2 G .....	\$255
Cabinet stand, 16-3/4" (426 mm).....	\$1,655
Stand, 8" (203 mm).....	\$865

<b>Standard parts and labor warranty, first year .....</b>	<b>No charge</b>
🛡️ Extended warranty, additional 12 months.....	NET \$1,075
🔧 MEIKO Pro-Activ Service, one year (see page 2).....	NET \$1,135
🔧 MEIKO Pro-Activ Service, two years (see page 2).....	NET \$2,260
Liftgate delivery .....	NET \$195
Notify before delivery fee.....	No charge
Inside delivery (consult factory with site details prior to quoting) .....	NET \$150
Guaranteed delivery date .....	Consult factory

DV 80.2 | Premium Class Door-Type 



The DV 80.2 tackles any job your kitchen can dish out. Fast loading combines with advanced features such as a quick start-up time, three different wash cycles, rapid tank regeneration, and a rear-vented door that safely directs steam away from the operator.

**CAPACITY:**  
61 racks / hour, 1,525 dishes / hour

**WATER CONSUMPTION:**  
45.14 gals. (170.87 liters) / hour  
0.74 gals. (2.80 liters) / rack

**WATER SUPPLY TEMPERATURE:**  
Any; 140°F (60°C) recommended

**VOLTAGES:**  
208-230V / 60Hz / 1Ph  
208-230V / 60Hz / 3Ph  
460V / 60Hz / 3Ph

**LIST PRICE:**  
**\$20,545**

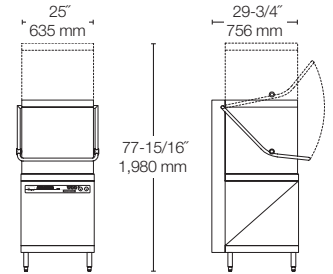

DV 80.2 | Premium Class Door-Type with Waste Air Heat Recovery System [WAHRS] 



The DV 80.2 with MEIKO's Waste Air Heat Recovery System smartly reclaims energy used during the wash cycle to preheat incoming rinse water, reducing heating time and saving money. This innovative, efficient design also runs on a **cold water supply** and requires no special ventilation.\*

**CAPACITY:**  
40 racks / hour, 1,000 dishes / hour

**WATER CONSUMPTION:**  
29.60 gals. (112.05 liters) / hour  
0.74 gals. (2.80 liters) / rack

**WATER SUPPLY TEMPERATURE:**  
Cold as available;  
70°F (21°C) maximum

**VOLTAGES:**  
208-230V / 60Hz / 1Ph  
208-230V / 60Hz / 3Ph  
460V / 60Hz / 3Ph

**LIST PRICE:**  
**\$24,515**

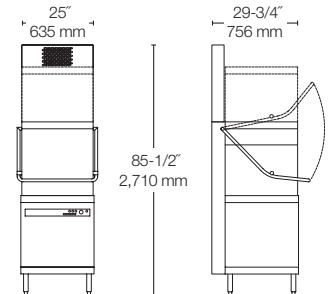

\*Subject to local code requirements.

### Options and Accessories for the DV Series Door-Type Warewashers

Drain water tempering kit (installed by others).....	\$925
Flanged feet.....	\$450
Peg rack, 20" x 20" (500 x 500 mm).....	\$110
Combination rack, 20" x 20" (500 x 500 mm).....	\$110
False front panel allows passthrough operation only, prevents operator from reaching into front of machine (factory installed).....	\$690

### Standard parts and labor warranty, first year..... **No charge**

🛡️ Extended warranty, additional 12 months.....	\$1,675
🔄 MEIKO Pro-Activ Service, one year (DV 80.2; see page 2).....	NET \$1,205
🔄 MEIKO Pro-Activ Service, two years (DV 80.2; see page 2).....	NET \$2,405
Liftgate delivery.....	NET \$190
Notify before delivery fee.....	Included
Inside delivery (consult factory with site details prior to quoting).....	NET \$150
Guaranteed delivery date.....	Consult factory
Liquid chemical dispenser pumps (NOW standard on this model)	
External vent fan control (NOW standard on this model)	



**FV 130.2 | Pot and Pan Washer** 



The FV 130.2 pot and pan washer is built to tackle larger washware such as pots, pans, trays and containers. It delivers first-class washing results with minimal use of water. But it has a soft side, too. Our Soft Start wash pump system keeps the pressure finely tuned, ensuring a delicate touch for delicate ware such as glasses. NSF / NSI 3 tested and listed.

**CAPACITY:**  
 20 cycles / hr.  
 32-3/8" x 26-1/2" (820 x 670 mm)  
 basket (up to 11 sheet pans)

**WATER CONSUMPTION:**  
 47.40 gals. (179.43 liters) / hour  
 2.37 gals. (8.97 liters) / cycle

**WATER SUPPLY TEMPERATURE:**  
 Any; 140°F (60°C) recommended

**VOLTAGES:**  
 208-230V / 60Hz / 3Ph  
 460V / 60Hz / 3Ph

**LIST PRICE:**  
**\$37,005**

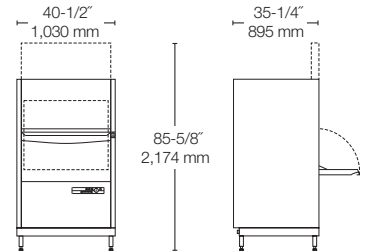

**FV 250.2 | Pot and Pan Washer** 



Larger ware and higher volumes are no match for the FV 250.2 heavy-duty pot and pan washer. Cleaning is a breeze thanks to smooth, stainless steel construction. Oscillating wash and rinse arms on top and bottom ensure perfect cleaning. And MEIKO's unique Auto Safe feature keeps wash and rinse temperatures perfectly adjusted, regardless of the incoming water supply temperature.

**CAPACITY:**  
 15 cycles / hour  
 50-1/2" x 26-1/2" (1,280 x 670 mm)  
 basket (up to 22 sheet pans with optional insert)

**WATER CONSUMPTION:**  
 38.25 gals. (144.79 liters) / hour  
 2.55 gals. (9.65 liters) / cycle

**WATER SUPPLY TEMPERATURE:**  
 Any; 140°F (60°C) recommended

**VOLTAGES:**  
 208-230V / 60Hz / 3Ph  
 460V / 60Hz / 3Ph

**LIST PRICE:**  
**\$48,495**

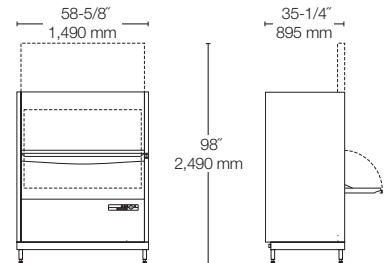

DV 270.2 | Door-Type Pot and Pan Washer



The DV 270.2 is MEIKO's best professional dishwasher! It has all the great features of the FV 250.2 with an even more robust construction. It tackles pots, pans, kitchen utensils, containers of all sizes and other tough-to-clean ware with ease. Tall and oversized wares? No problem! The DV 270.2 can wash up to 22 standard 18" x 26" (457.2 mm x 660.4 mm) sheet pans in each 4-minute cycle, and can complete 15 cycles per hour.

It can also double as a dishwasher for more delicate ware. The integrated **Soft Start wash** pump system keeps the pressure finely tuned to protect fine glassware and china from chipping and breaking. If you need a heavy-hitter in your busy kitchen, this is the best commercial pot and pan dishwasher for you.

**CAPACITY:**  
 15 cycles / hour  
 50-1/2" x 26" (1,280 x 660 mm)  
 basket (up to 22 sheet pans with  
 optional insert)

**WATER CONSUMPTION:**  
 38.25 gals. (144.79 liters) / hour  
 2.55 gals. (9.65 liters) / cycle

**WATER SUPPLY TEMPERATURE:**  
 Any; 140°F (60°C) recommended

**VOLTAGES:**  
 208-230V / 60Hz / 3Ph  
 460V / 60Hz / 3Ph

**LIST PRICE:**  
**\$58,910**

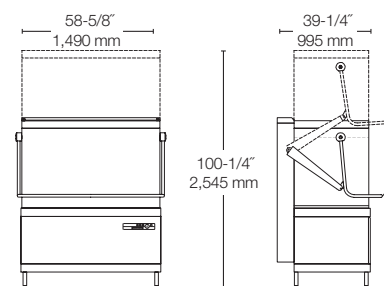

**Options and Accessories for the FV and DV Series Pot and Pan Washers**

Drain water tempering kit .....	\$925
Power vent option, includes fan and connection for indirect vent (FV 130.2, FV 250.2 only).....	\$5,750
Power vent adapter option, provides direct vent connection (FV 130.2, FV 250.2 only, power vent option required).....	\$1,255
Flanged feet .....	\$450
Sheet pan insert (FV 250.2, DV 270.2 only).....	\$610
Extra wheeled basket (DV 270.2 only, sheet pan inserts not included) .....	\$2,300
Peg rack, 20" x 20" (500 x 500 mm) .....	\$110
Combination rack, 20" x 20" (500 x 500 mm).....	\$110
Correctional package.....	\$3,415
Liquid chemical dispenser pumps (NOW standard on this model)	
External vent fan control (NOW standard on this model)	

<b>Standard parts and labor warranty, first year .....</b>	<b>No charge</b>
Extended warranty, additional 12 months.....	NET \$3,540
MEIKO Pro-Activ Service, one year (FV130.2, FV250.2, DV270.2; see page 2) .....	NET \$1,205
MEIKO Pro-Activ Service, two years (FV130.2, FV250.2, DV270.2; see page 2) .....	NET \$2,405
Liftgate delivery .....	NET \$250
Notify before delivery fee.....	Included
Inside delivery (consult factory with site details prior to quoting) .....	NET \$350
Guaranteed delivery date.....	Consult factory

## KA SERIES | Rack-Conveyor Dishwashers

### MEIKO's unique rack machine with a 90° unloader/blower dryer module **GIVES YOU OPTIONS!**

The KA Series from MEIKO delivers superior performance and exceptional value. Advanced technology and smart design make it easy to use, and its extremely low water and energy consumption helps reduce costs and waste.

**You save with every wash – money that can go right back to the bottom line!**

The high-contrast, intuitive touchscreen shows operational information and machine functions in graphics, as well as plain text, so it's easy to read and understand.

#### Other great standard KA features:

- Glass touchscreen offers multiple language options to help lower the chance of operator error.
- Get simplified service diagnostics, error logging, troubleshooting and real-time performance updates.
- **Modular design** lets you choose from multiple configurations for maximum flexibility in small and tight kitchens.
- Sealed, reversible hinged doors.
- Three conveyor speeds are available to handle most soil loads.
- Built-in auto-adjusting booster heater for peace of mind.

#### Optional features

- Waste Air Heat Recovery System (WAHRS)
- High-efficiency blower-dryer unit
- 90° unloader/blower-dryer unit
- 90° loaders/unloaders

#### Conveyor speed

**KA-44 / 66 / 80; KA-54 / 76 / 90:**  
- 6.75 feet (2.01 meters) / minute

**KA-64 / 86 / 100:**  
- 9.88 feet (3.01 meters) / minute



Double-wall insulation is cool to the touch

**Low water consumption**  
86 gallons (325.5 liters) per hour - just 0.24 gallons (0.91 liters) per rack

**A built-in "smart" booster heater ensures** correct sanitizing temperature of 180°F (82°C) whenever incoming water temperatures vary between 110°-140°F (43.3°-60°C)

### KA SERIES | Performance Data

**MAX RACKS PER HOUR:**  
**KA-44 / 66 / 80:**  
NSF rated 243, adjustable

**KA-54 / 76 / 90:**  
NSF rated 243, adjustable

**KA-64 / 86 / 100:**  
NSF rated 355, adjustable

**MAX WATER CONSUMPTION:**  
**KA-44 / 66 / 80:**  
71.0 gals. (268.7 liters) / hour  
0.29 gals (1.1 liters) / rack

**KA-54 / 76 / 90:**  
71.0 gals. (268.7 liters) / hour  
0.29 gals (1.1 liters) / rack

**KA-64 / 86 / 100:**  
86 gals (325.5 liters) / hour  
0.24 gals (0.92 liters) / rack

**AVAILABLE VOLTAGES:**  
208V / 60Hz / 3Ph  
230V / 60Hz / 3Ph  
460V / 60Hz / 3Ph

### KA SERIES | Hot-Water Sanitizing, Single-Tank Dishwashers

KA-44	KA-66	KA-80
44" (1,118 mm) compartment with wash and final rinse zones	44" (1,676 mm); adds 22" (559 mm) prewash section to KA-44 configuration	44" (2,032 mm); adds 36" (914 mm) prewash section to KA-66 configuration
<b>LIST PRICE:</b> K-44 <b>\$39,180</b>	<b>LIST PRICE:</b> K-66 <b>\$57,085</b>	<b>LIST PRICE:</b> K-80 <b>\$62,855</b>
KA-54	KA-76	KA-90
54" (1,372 mm) compartment with wash and final rinse zones	76" (1,931 mm); adds 22" (559 mm) prewash section to KA-54 configuration	90" (2,172 mm); adds 36" (914 mm) prewash section to KA-54 configuration.
<b>LIST PRICE:</b> K-54 <b>\$53,500</b>	<b>LIST PRICE:</b> K-76 <b>\$74,480</b>	<b>LIST PRICE:</b> K-90 <b>\$73,100</b>

### KA SERIES | Hot-Water Sanitizing, Multiple-Tank Dishwashers

KA-64	KA-86	KA-100
64" (1,626 mm) compartment with wash and final rinse zones	86" (2,184 mm); adds 22" (559 mm) prewash section to KA-64 configuration	100" (2,540 mm); adds 36" (914 mm) prewash section to KA-64 configuration
<b>LIST PRICE:</b> K-64 <b>\$65,525</b>	<b>LIST PRICE:</b> K-86 <b>\$89,910</b>	<b>LIST PRICE:</b> K-100 <b>\$95,410</b>



Easy-to-read glass touchscreen displays cycle status, operational information and other functions.



Computer-designed wash arm spray patterns.



Completely customizable, modular design solves kitchen space problems.



Field-reversible sealed, hinged doors.

### Options and Accessories for the KA Series Rack-Conveyor Dishwashers

Integral Waste Air Heat Recovery System (allows operation from cold water supply) .....	\$9,515
Table limit switch with 25' of cord .....	\$455
Peg rack, 20" x 20" (500 x 500 mm) .....	\$110
Combination rack, 20" x 20" (500 x 500 mm).....	\$110
Open-ended sheet pan rack.....	\$450
Drain water tempering kit (installed by others).....	\$1,525
Water hammer arrestor .....	\$270
Power loader.....	\$8,825
Power unloader.....	\$8,825
Integral blower-dryer, electric, extends machine length by 23 5/8" (600 mm) .....	\$14,875
90° loader, mechanically driven, extends length by 34-1/4" (870 mm) .....	\$9,535
90° unloader, mechanically driven, extends length by 34-1/4" (870 mm) .....	\$9,535
90° blower/dryer unloader, mechanically driven, extends length by 34-1/4" (870 mm) .....	\$14,875
Flanged feet (set of 4, for KA-44 / KA-64).....	\$485
Flanged feet (set of 6, for KA-66 / 80 / 86 / 100).....	\$620
Correctional package.....	Consult factory
<b>Standard parts and labor warranty, first year .....</b>	<b>No charge</b>
🛡️ Extended warranty, additional 12 months (KA-44 / 66 / 80) .....	NET \$2,155
🛡️ Extended warranty, additional 12 months (KA-64 / 86 / 100) .....	NET \$3,085
🔧 MEIKO Pro-Activ Service, one year (see page 2).....	NET \$2,160
🔧 MEIKO Pro-Activ Service, two years (see page 2).....	NET \$4,320
Liftgate delivery.....	NET \$250
Notify before delivery fee.....	Included
Inside delivery (consult factory with site details prior to quoting) .....	NET \$350
Guaranteed delivery date.....	Consult factory

M-iQ SERIES | Features 



**MTS918** | **M-iQ B-M74 V6 N02 P8** | Standard Flight Conveyor MTS Configuration

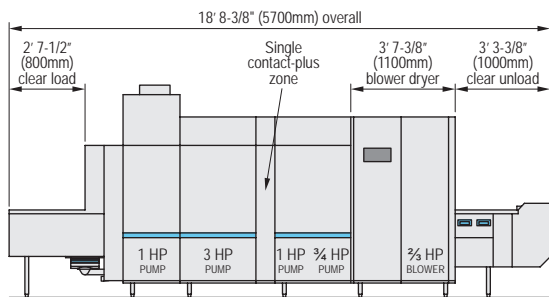

- Powerful compact prewash, wash, power rinse, final rinse, small blower dryer
- One Contact-Plus zone between wash and final rinse [N02]
- Ideal for extremely limited spaces
- Overall length is 18' 8-3/8" (5,700 mm)

[CONSULT FACTORY FOR PRICING](#)

**MTS1** | **M-iQ B-M74 V6 N02 P8** | Standard Flight Conveyor MTS Configuration

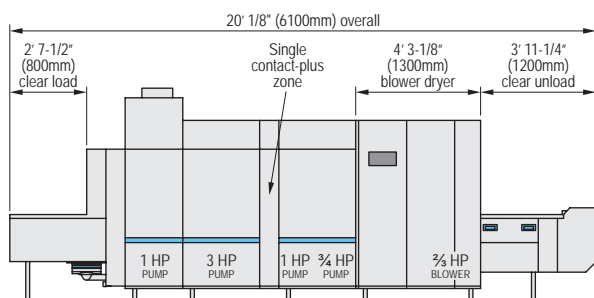

- Standard prewash, wash, power rinse, final rinse, blower dryer
- One Contact-Plus zone between wash and final rinse [N02]
- Ideal for trayless cafeterias, or where space is limited
- Overall length is 20' 1/8" (6,100 mm)

[CONSULT FACTORY FOR PRICING](#)

**MTS2** | **M-iQ B-M74 V8 N22 P8** | Standard Flight Conveyor MTS Configuration

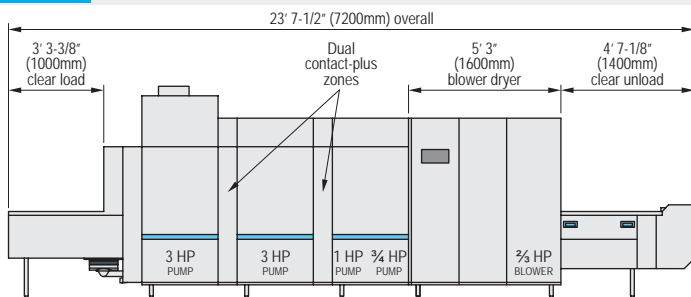

- Large prewash, wash, power rinse, final rinse, blower dryer
- Dual Contact-Plus zones [N22]
- Ideal for general purpose use such as cafeterias with trays, hospitals, limited number of sheet pans
- Overall length is 23' 7-1/2" (7,200 mm)

[CONSULT FACTORY FOR PRICING](#)



MODEL	B-S74 P8	B-M74 V6 P8	B-M74 V8 P8	B-L74 V6 P8	B-L74 V8 P8	B-XL74 V6 P8	B-XL74 V8 P8
PREWASH	—	1 hp	3 hp	1 hp	3 hp	1 hp	3 hp
WASH	1 x 3 hp	1 x 3 hp	1 x 3 hp	2 x 3 hp	2 x 3 hp	3 x 3 hp	3 x 3 hp
POWER RINSE	1 hp	1 hp	1 hp	1 hp	1 hp	1 hp	1 hp
FINAL RINSE	3/4 hp	3/4 hp	3/4 hp	3/4 hp	3/4 hp	3/4 hp	3/4 hp
BELT SPEED	4.5 feet / minute	6 feet / minute	6.5 feet / minute	8.3 feet / minute	9 feet / minute	9 feet / minute	9 feet / minute
DISHES / HOUR	7,503	10,005	10,838	13,840	15,007	15,007	15,007
WATER	56.8 GPH	56.2 GPH	56.8 GPH	57.87 GPH	58.95 GPH	58.95 GPH	58.95 GPH

M-iQ SERIES | Features and Options

- **GreenEye™** An optional integrated system that includes:
  - **GreenCoach™** Interactive lights suggest optimal loading “lanes” on the belt, increasing efficiency.
  - **GreenFilter™** A dedicated hydrocyclone separator in the power rinse tank continuously removes even the finest soil particles to reduce detergent use and improve wash results.
  - **M-iQ Synergies** Promotes maximum teamwork between the operator and machine.
- Multiple conveyor belt styles are available to support a variety of ware types [choose from 3 standard options; custom options are also available]
- Multiple fully-integrated blower drying options are available [up to 4].
- **Unique Contact-Plus zones** between tank sections minimize soil carry-over to reduce detergent use and improve wash results.
- Steam coil or electric heat [tank or dryer].
- **Available in these power configurations:** 208V / 60Hz / 3Ph || 230V / 60Hz / 3Ph || 460V / 60Hz / 3Ph

Options and Accessories for MTS918, MTS1, MTS2

<b>GreenEye™</b> (optional integrated system) .....	\$11,775
<b>Standard parts and labor warranty, first year</b> .....	<b>No charge</b>
 Extended warranty, additional 12 months (electric).....	\$5,785
 Extended warranty, additional 12 months (steam) .....	\$5,785
 MEIKO Pro-Activ Service, one year (see page 2) .....	\$1,990
 MEIKO Pro-Activ Service, two years (see page 2) .....	\$3,980
Drain water tempering kit (installed by others) .....	\$1,405



**AZP 80** | **Waste Pulper** 



Whether left on a diner’s plate or generated in the kitchen during preparation, food waste simply can’t be avoided. Typical kitchen waste with its high water content generates difficult storage and disposal problems. It can also incubate diseases and create odors. MEIKO’s AZP 80 is an advanced, high-capacity waste pulper that can reduce food and mixed-waste volume by as much as 85%.

The AZP 80 shreds food residues in a horizontally arranged shredding unit. Integrated pump blades then create suction that move the residues to a separator for draining.

**The end product:** Relatively dry, odorless pulp that’s easier to dispose of. Once waste has been pulped, an automatic self-cleaning cycle helps maintain sanitation and cleanliness.

**FOOD WASTE CAPACITY:**

992 lbs. (450 kg) / hour

**MIXED WASTE CAPACITY:**

705 lbs. (320 kg) / hour

**COLD WATER CONSUMPTION:**

39.6 gals. (150 liters) / hour

**HOT WATER CONSUMPTION:**

2.8 gals. (10.5 liters) / hour

7.9 gals. (30 liters) at shutdown

**HOT WATER CONSUMPTION:**

2.8 gals. (10.5 liters) / hour

7.9 gals. (30 liters) at shutdown

**AVAILABLE VOLTAGES:**

208V / 60Hz / 3Ph

230V / 60Hz / 3Ph

460V / 60Hz / 3Ph

**CONSULT FACTORY FOR PRICING AND AVAILABILITY**

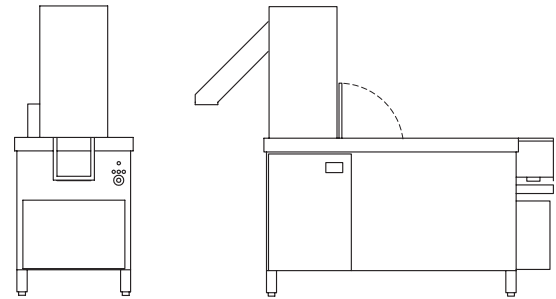



Dimensions for Model AZP 80 vary based on configuration. Consult specification sheet for details.



**Options and Accessories for the AZP 80 Waste Pulper**

- 1.0 hp (0.75 kW) recirculation pump *(for a 20-ft. trough)*
- 2.1 hp (1.6 kW) recirculation pump *(for a 20-40-ft. trough)*
- Remote control panel
- Anti-vibration feet
- Correctional package

**Standard parts and labor warranty, first year**

-  Extended warranty, additional 12 months
-  MEIKO Pro-Activ Service, one year (see page 2 for information)
-  MEIKO Pro-Activ Service, two years (see page 2 for information)



# STANDARD LIMITED WARRANTY PROGRAM | MEIKO USA, INC. | Effective January 1, 2022

For international information, contact MEIKO's Service Department at 1-800-868-3840 or e-mail: service@meiko.us.

## MEIKO STANDARD LIMITED WARRANTY PROGRAM—MEIKO USA, INC. [Effective January 1, 2022]

For international information, contact MEIKO's Service Department at 1-800-868-3840 or e-mail: service@meiko.us.

### COMMITMENT

MEIKO USA, Inc. (MEIKO) has a nationwide, factory-trained and certified network of highly quality Authorized Service Agents and Sub-Agents to support all your needs. With spare parts strategically placed throughout North America, a fully-stocked warehouse and showroom at our factory in Nashville, and factory-trained technicians available 24/7, help is only a phone call away! We know your commercial kitchen doesn't work from 9:00 a.m.-5:00 p.m., and neither do we. We're available **24/7/365** for technical support or to arrange a warranty service call if needed. **Your uninterrupted operation is our #1 priority!**

### WARRANTY PERIOD

**Unless otherwise agreed to in writing by a MEIKO representative and the Customer at the time of sale, all MEIKO equipment is warranted for one (1) year parts and labor from the original equipment installation date.** This warranty is valid to the original equipment owner only, and is non-transferable. **MEIKO's warranty coverage is valid 24 hours a day, 7 days a week, 365 days a year with NO PREMIUM CHARGES TO THE CUSTOMER!** To ensure serve to you, all MEIKO Authorized Service Agents in North America have programs in place to manage around-the-clock service needs.

MEIKO's warranty begins when the Customer requests a P&I (Performance and Installation Inspection) from their local MEIKO Authorized Service Agent (ASA) after the equipment has been installed by others. Please check our website at [www.meiko.us](http://www.meiko.us) to determine the name of your local ASA. He or she will verify the machine's proper installation and operation, record your facility's name and equipment information for the factory, and ensure the operator knows who to call in the event of a problem. The warranty period will then commence. MEIKO offers this P&I free of charge to the Customer.

### COVERAGE

MEIKO warrants to the original purchaser all new equipment to be free of defects in material or workmanship for the length of time specified within this Limited Warranty Period. MEIKO's warranty coverage is expressly limited to mechanical failures that occur during normal operation of the equipment. Specific coverage not implied by this warranty includes, but is not limited to: failures due to lack of cleaning or proper maintenance, misuse, abuse, and modifications by unauthorized personnel. Failures deemed to be caused by lack of maintenance or upkeep will not be covered under MEIKO's limited warranty coverage.

The liability of MEIKO on any claim including warranty or other, contracted, expressed or implied negligence, strict liability, or other theories shall constitute solely and prohibitively the repair or replacement of the warranted product.

## TERMS AND CONDITIONS | MEIKO USA, INC. | Effective January 1, 2022

For international information, contact MEIKO at 615-399-6600 or sales@meiko.us.

- This price list supersedes all previous price lists. All orders accepted are subject to prices and taxes in effect at the time of shipment. All prices in this list are subject to change without notice. All specifications are subject to change without notice based on MEIKO's dedicated product improvement program.

Other such liability of MEIKO shall not include, and the Customer specifically renounces any rights to recover, special, collateral, consequential, incidental or other injuries to persons or damage to property, loss of profits or anticipated profits, or loss of product use. For additional items not covered under warranty, see EXCLUSIONS.

### EXCLUSIONS

**The Limited Warranty Program does not cover:**

- 1) Defects resulting from improper installation or maintenance, modification or alteration, misuse, abuse, lack of cleaning and routine maintenance or other conditions not attributed to a defect in material or workmanship of the product. Clogged drains (internal/external) are not covered under this limited warranty program.
- 2) Damage due to fire, floods, acts of God, accidents, or damage incurred in transit.
- 3) Equipment with missing or altered serial plates.
- 4) Normal wear parts including, but not limited to, lamps, interior/exterior finishes (cosmetic damage), damaged wash/rinse arms, clogged spray nozzles, loose piping, worn curtains, chemical tubing, hoses, etc.
- 5) Defects resulting from the use of improper cleaning materials including, but not limited to, metal scouring pads, unapproved chemicals such as chlorine bleach, etc.
- 6) Adjustments pertaining to leveling, improper installation, tightening of fasteners or plumbing connections, etc.
- 7) Equipment installed or operated outside of the 50 United States, its territories, or Canada.

### CUSTOMER ASSURANCES

For MEIKO to effectively fulfill its commitment to you, we need your cooperation to quickly resolve service issues. Fast and efficient service requires the operator to comply with several responsibilities. Warranty coverage may be denied in the event of noncompliance with the following:

- Accessibility of product during normal business hours.
- Cooperation by the manager on duty with the ASA during diagnosis and repair.
- MEIKO or the local ASA is contacted within 48 hours of a known defect.
- The equipment has been, and will be, properly maintained, including regularly scheduled preventive maintenance programs
- MEIKO's warranty covers service 24/7/365 for emergency repairs. Scheduled service calls and call-backs from previous service calls (*i.e.*, repeat trips or second trips needed to install diagnosed components) must be performed within the normal business hours of the ASA.

MEIKO USA, INC. RESERVES THE RIGHT TO MODIFY AND AMEND ITS WARRANTY PROGRAM AT ANY TIME. WARRANTY FOR PRODUCTS SOLD DURING THE TIME OF A SPECIFIC WARRANTY POLICY WILL BE HONORED FOR THE DURATION OF THE STATED WARRANTY AT THE TIME OF SALE.

- All prices are in U.S. dollars. Payments are to be made in U.S. dollars.
- **Standard Terms and Conditions apply.** They are available on request and are provided with every sales quote. Contact us at : **SALES@MEIKO.US; 800-55MEIKO or (615)399-6600.**

**USA Equipment Performance and Installation Inspection Program (P&I Program)\***  
**NOTE: COMPLETION OF THE PERFORMANCE AND INSTALLATION INSPECTION (P&I)**  
**ACTIVATES THE CUSTOMER'S WARRANTY.**

**Policy Effective January 1, 2022**

**THE PURPOSE OF THIS PROGRAM IS TO ENSURE:**

- The customer's new equipment has been installed and set up correctly.
- Water, drain, chemicals (where applicable) and electric supplies are correct.

**THIS PROGRAM IS PROVIDED AT NO ADDITIONAL CHARGE TO CUSTOMERS IN THE 50 UNITED STATES.**

- MEIKO will pay for Service Agency labor for one Service Technician during normal working hours (8:00 AM-5:00 PM weekdays).
- A normal inspection takes approximately 60-90 minutes plus normal travel.
- All after hours or weekend premium charges over and above normal rates are to be paid by the customer.
- If the installation is not complete when the Service Agent's technician arrives and as a result, he/she is unable to complete the inspection provided by this program, the Service Agency may charge the customer for the additional mileage and travel time (no labor) for any additional trips to the job site.

**PRIOR TO EQUIPMENT DELIVERY, THE CUSTOMER SHOULD:**

- Call the local Service Agency five or more days before delivery to schedule the inspection. This will allow the Service Agency sufficient time to adjust the Technician's schedule and reserve the time required to perform the inspection.
- Have all utilities such as water, electricity, chemicals (where applicable) and drain installed, operational and in compliance with MEIKO's specifications before the Technician arrives.

**WHEN THE NEW EQUIPMENT ARRIVES, THE CUSTOMER SHOULD:**

- Inspect the equipment to ensure it arrived in good condition and that no freight damage occurred in transit. If freight damage is discovered upon delivery, please refuse delivery of the machine, make note of the damage on the delivery documents, and notify your Sales Representative immediately for a replacement order.
- Make arrangements with their chosen contractor to uncrate, position and install the equipment in accordance with the Installation and Operating instructions provided by MEIKO.
- Make arrangements to have a licensed plumber and/or electrician present to do the final hook-ups. This is normally required by local codes. Check with your contractor or local Service Agency to verify if this is required.

**DURING THE PERFORMANCE AND INSTALLATION INSPECTION (AFTER INSTALLATION), THE MEIKO AUTHORIZED SERVICE AGENT WILL:**

- Send one qualified Service Technician to perform the New Equipment Performance and Installation Inspection.
- Inspect the new equipment to verify that all parts and accessories were correctly shipped, have arrived in good condition, and have been properly installed.
- Check all aspects of the installation and operation, as stated in our New Equipment Performance and Installation Inspection checklist.
- Complete the New Equipment Performance and Installation Inspection checklist.
- Review the checklist and warranty with the customer.
- Have the customer sign the checklist.

**AFTER THE P&I IS SCHEDULED, THE CUSTOMER SHOULD:**

Call their local MEIKO sales representative to schedule a comprehensive product demonstration upon completion of the P&I.

**NOTE:** During this demonstration, the customer should have all employees who will be using the equipment present for training on its proper use, cleaning and maintenance. Local sales representatives can be found by visiting [www.meiko.us](http://www.meiko.us).

**THE PERFORMANCE AND INSTALLATION INSPECTION DOES NOT ELIMINATE NOR TAKE THE PLACE OF THE MEIKO SALES REPRESENTATIVE'S COMPREHENSIVE DEMONSTRATION OF THE NEW MEIKO EQUIPMENT.**

The MEIKO sales representative should be present for the Performance and Installation inspection, and should perform the demonstration at the conclusion of the inspection.

\* For international information, contact MEIKO at 615-399-6600 or 800-55-MEIKO.

